

**ARCHWAY**  
CUSTOM HOMES

**2**  
OPPORTUNITIES  
REMAINING

**KILLIAN**  
MANOR

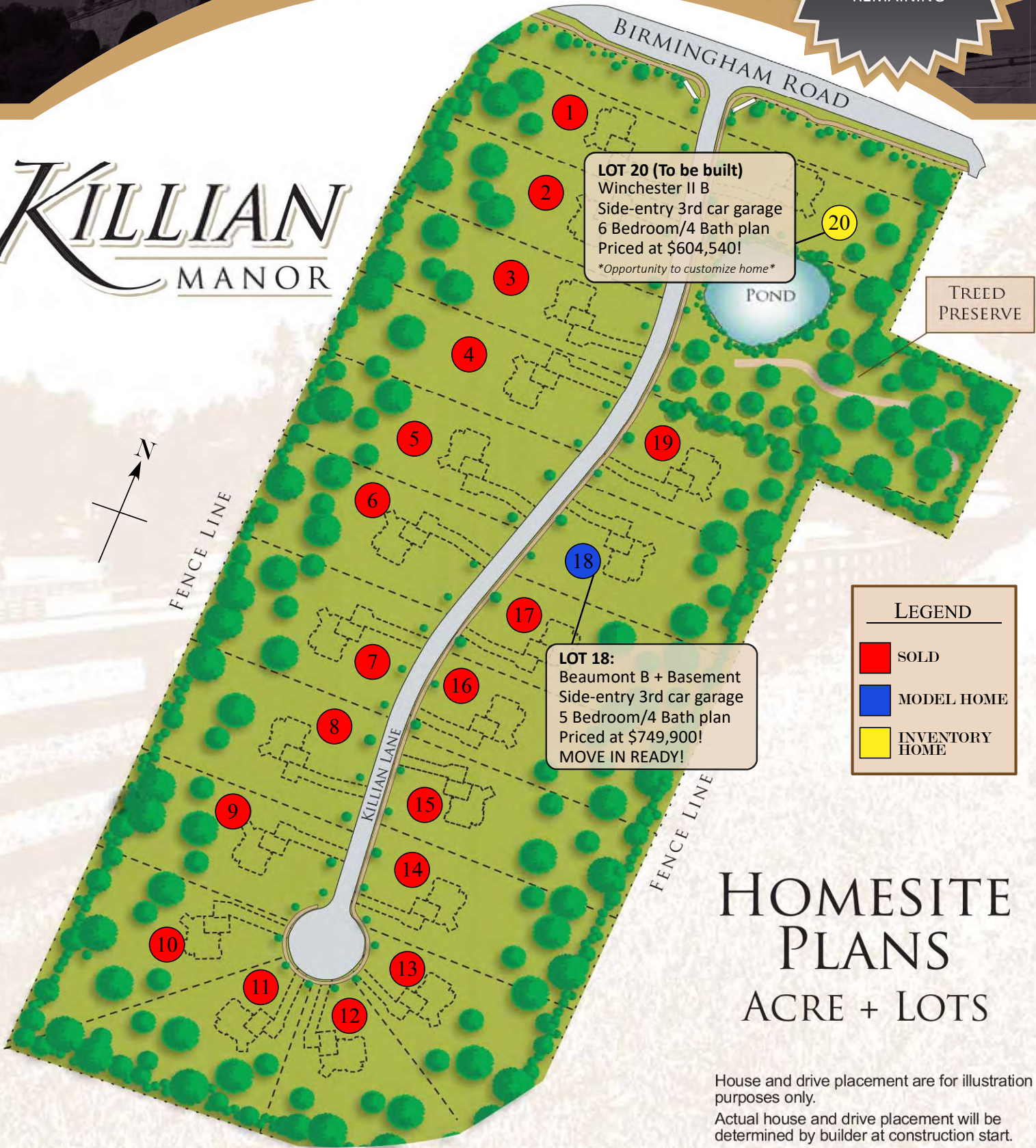

**LOT 20 (To be built)**  
Winchester II B  
Side-entry 3rd car garage  
6 Bedroom/4 Bath plan  
Priced at \$604,540!  
*\*Opportunity to customize home\**

**LOT 18:**  
Beaumont B + Basement  
Side-entry 3rd car garage  
5 Bedroom/4 Bath plan  
Priced at \$749,900!  
MOVE IN READY!

LEGEND	
<span style="color: red;">■</span>	SOLD
<span style="color: blue;">■</span>	MODEL HOME
<span style="color: yellow;">■</span>	INVENTORY HOME

**HOMESITE  
PLANS  
ACRE + LOTS**

House and drive placement are for illustration purposes only.  
Actual house and drive placement will be determined by builder at construction start.